

INTERVENTO RESIDENZIALE
BORGO PANIGALE
 Via Elio Bragaglia - Via Lorenzo di Bagnomarino

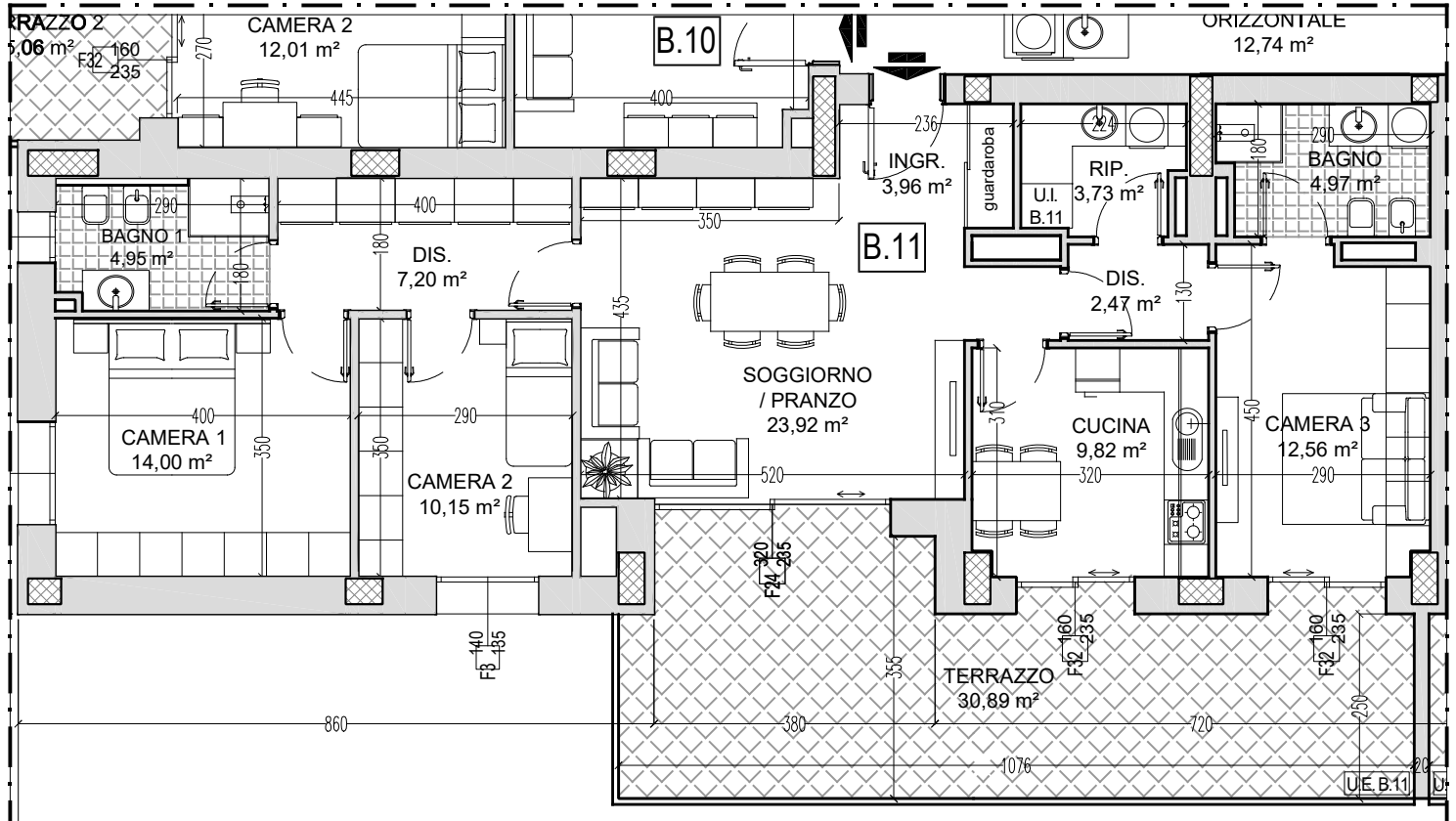

| | |
|--|---------------------------|
| APPARTAMENTO | 122,13 x 100% = 122,13 mq |
| TERRAZZO 1 | 32,21 x 50% = 16,11 mq |
| SUPERFICIE LORDA COMMERCIALE TOTALE (S.L.V.) | = 138,24 mq |



EDIFICIO B

ALLOGGIO B.11

PIANO SECONDO

Scala 1:100

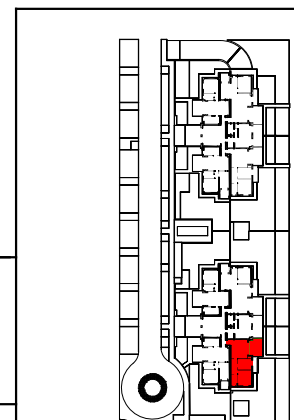
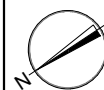

NOTA: le misure sono indicative e possono subire variazioni in cantiere